

Wes-Tex Groundwater Conservation District
100 East Third Street, Suite 305 B
Sweetwater, Texas 79556
325-236-6033
westexgcd.org

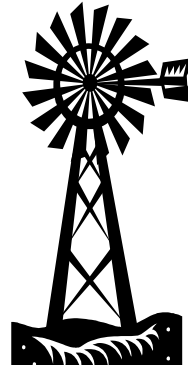

FOR DISTRICT USE ONLY

Well Number _____
Application Date _____
Rec'd By _____
Completion Date _____

Application for Water Well Registration

1. Well Owner _____
Property Owner & Address, if not well owner _____
Address _____ City _____ State _____ Zip _____
Phone _____ Fax _____
E-Mail _____
911 System address of property of well location _____

Notice: All Irrigation or Non-Exempt Wells, regardless of casing diameter must be spaced a minimum of 300 feet from the nearest property line and a minimum of 600 feet from any existing well.

2. Well Location _____ County Nolan
NW $\frac{1}{4}$ NE $\frac{1}{4}$ SW $\frac{1}{4}$ SE $\frac{1}{4}$ Section _____ Block _____ Survey _____
(Circle One that Applies)
_____ miles N or S and _____ miles E or W of the town of _____
(Circle) (Circle)
_____ measured yards N or S (property) or (section) line and
(Circle all that apply)
_____ measured yards E or W, (property) or (section) line
(Circle all that apply)
_____ measured yards from nearest existing well. Name of nearest well owner,
if not applicant _____.
Latitude _____ Longitude _____ (if known)

3. Well Description:
Anticipated Drill Date _____ (If an existing well, then drill date)
Driller _____
Casing Size _____ Pump Size _____ Depth (if known) _____
Estimated or anticipated annual pumpage _____
Estimated or anticipated GPM _____

4. Well Use: Domestic Municipal Industrial Commercial Livestock Irrigation
(Circle One that Applies)

Other _____ Please Explain Other

Is, or will, water produced from this well be exported beyond the boundaries of Nolan County? _____ If yes, please explain _____

5. Locate well by marking a dot inside a circle (•) **within the grid** to show proposed or existing well locations. The grid represents one section or square mile as described on page 1.

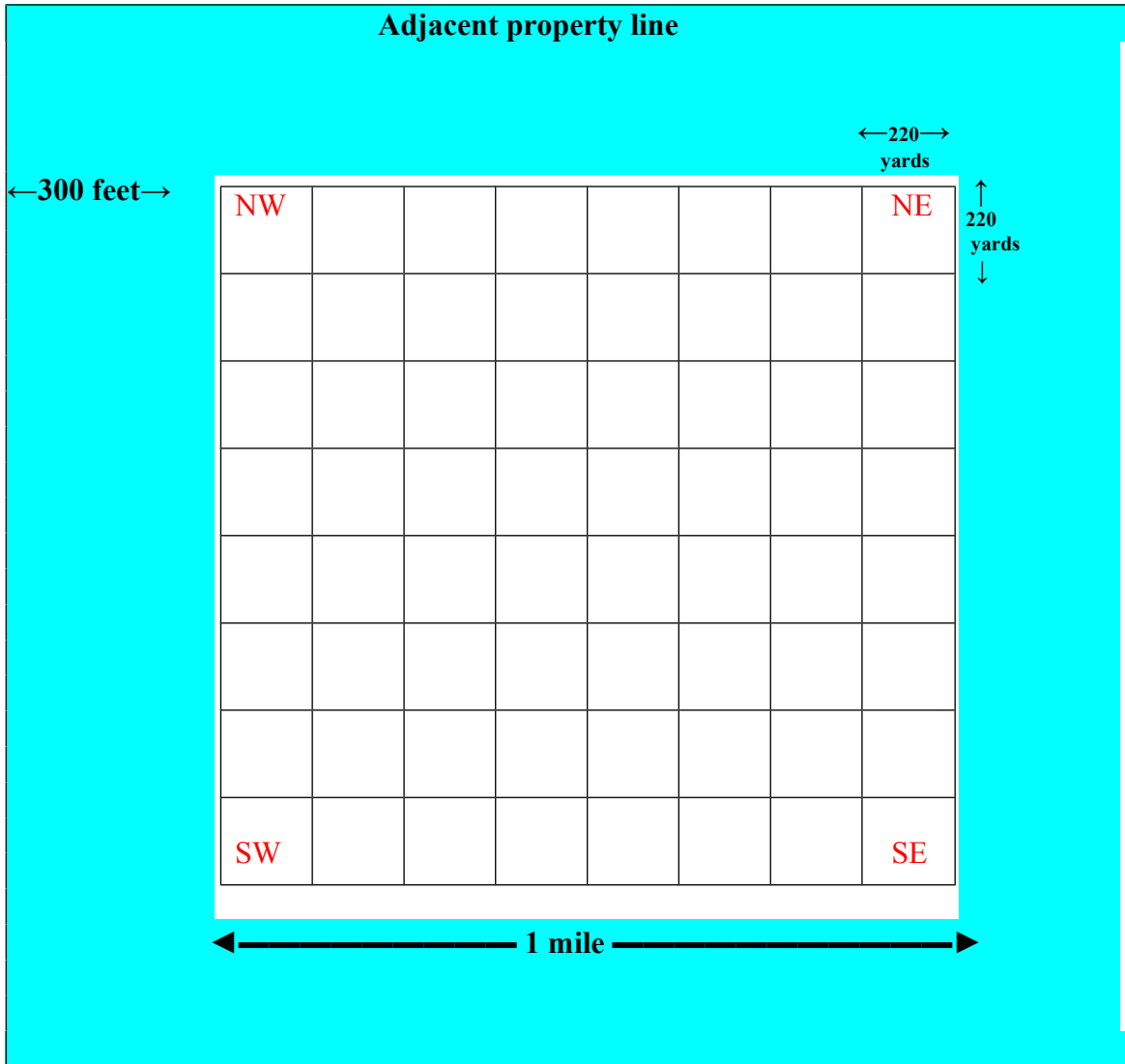

I agree that this well exists or will be drilled within 250 feet of the location specified and not elsewhere, while in accordance to the spacing requirements as set up within the Wes-Tex GCD (Nolan County) Rules and that I will furnish the Board of Directors the completed well log immediately upon completion of this well and prior to the production of water. (This is not a requirement if the well is in existence as of 8/31/04.) I agree that the water withdrawn under this application will be put to a beneficial, non wasteful use, and that I will comply with all Wes-Tex GCD District Rules, orders, and permit provisions. I will comply with water well plugging and capping guidelines set forth by the District. I understand that all spacing requirements or production maybe subject to inspection by the Water District under Chapter 36.123 to assure compliance. I hereby certify that I have read the foregoing statements and that all data therein contained are true and correct to the best of my knowledge and belief.

This notice given by:

(Signature of Owner or Agent)

Title

I, hereby, certify that this application has been verified and is in compliance with the Rules of the District.

District Manager

Date