

Wes-Tex Groundwater Conservation District
100 East Third Street, Suite 305 B
Sweetwater, Texas 79556
325-236-6033
westexgcd.org

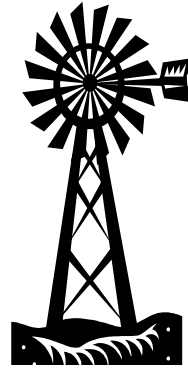

FOR DISTRICT USE ONLY

Well Number _____
Application Date _____
Rec'd By _____
Completion Date _____

Application for ONE EXEMPT Water Well Registration Permit

1. Well Owner _____
Property Owner & Address, if not well owner _____
Address _____ City _____ State _____ Zip _____
Phone _____ Fax _____
E-Mail _____
911 System address of property of well location _____

Notice: Exempt wells may only be used for purposes such as House, Livestock or purposes up to 25000 gals per day(17.37 gals per minute over a 24 hour period.)
An Exempt Well can not be used along with a non-exempt well or it will be considered an illegal water well.

2. Well Location _____ County Nolan
NW $\frac{1}{4}$ NE $\frac{1}{4}$ SW $\frac{1}{4}$ SE $\frac{1}{4}$ Section _____ Block _____ Survey _____
(Circle One that Applies)

_____ miles N or S and _____ miles E or W of the town of _____
(Circle) (Circle)
_____ measured yards N or S (property) or (section) line and
(Circle all that apply)
_____ measured yards E or W, (property) or (section) line
(Circle all that apply)

_____ measured yards from nearest existing well. Name of nearest well owner,
if not applicant _____.

Latitude _____ Longitude _____ (Required for permit)

3. Well Description:

Anticipated Drill Date _____ (If an existing well, then drill date)

Driller _____

Casing Size _____ Pump Size _____ Depth (if known) _____

Estimated or anticipated annual pumpage _____

Estimated or anticipated GPM _____

4. Well Use: Domestic Municipal Industrial Commercial Livestock Irrigation
(Circle One that Applies)

Other _____ Please Explain Other

Is, or will, water produced from this well be exported beyond the boundaries of Nolan County? _____ If yes, please explain _____

5. Locate well by marking a dot inside a circle (•) **within the grid** to show proposed or existing well locations. The grid represents one section or square mile as described on page 1.

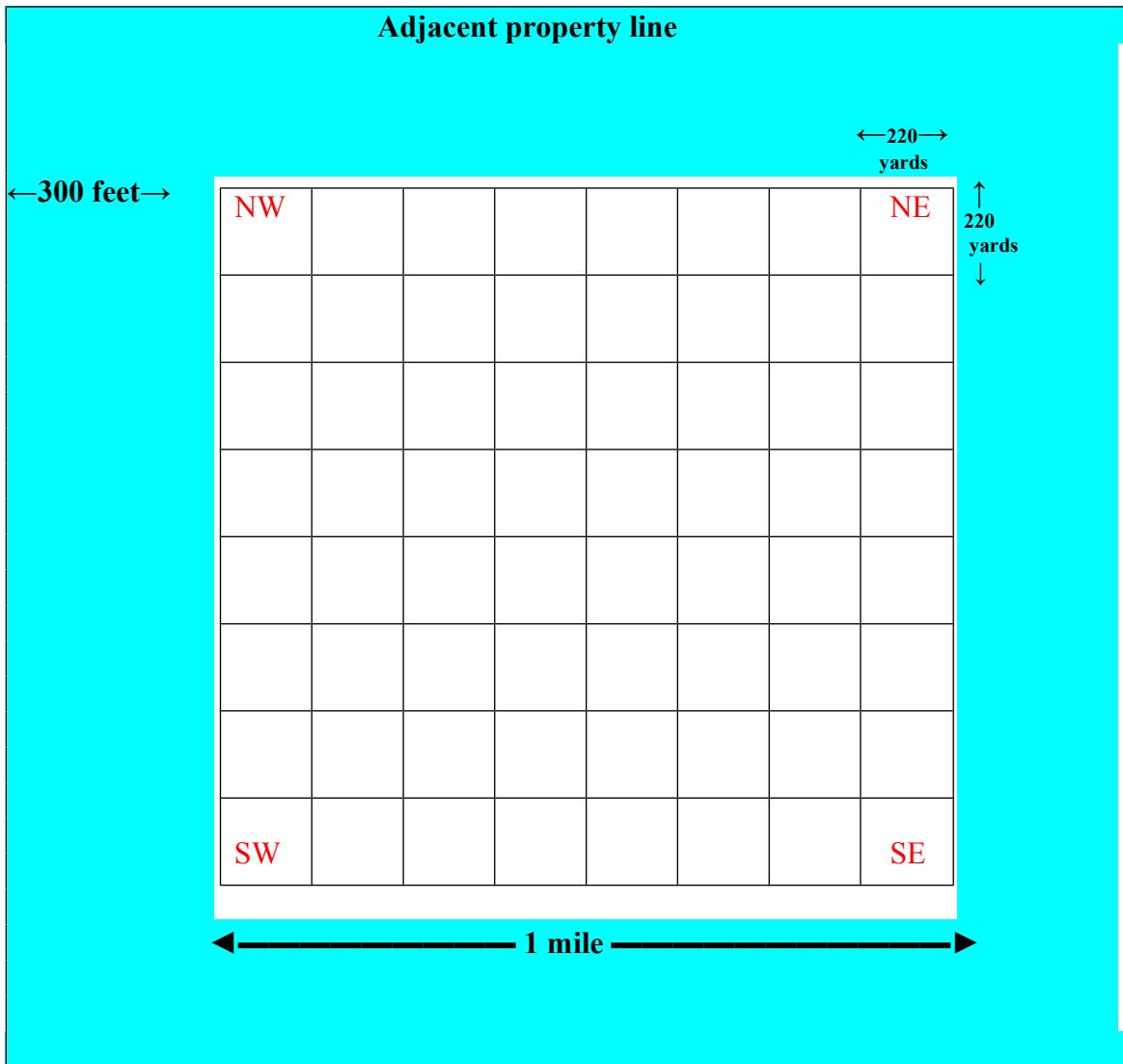

I agree that this well exists or will be drilled within 3-4 feet of the location specified and not elsewhere, while in accordance to the Wes-Tex GCD (Nolan County) Rules and that I will furnish the Board of Directors the completed well log immediately upon completion of this well and prior to the production of water. I agree that the water withdrawn under this application will be put to a beneficial, non wasteful use, and that I will comply with all Wes-Tex GCD District Rules, orders, and permit provisions. I will comply with water well plugging and capping guidelines set forth by the District. Permit Applications must be approved prior to commencement of drilling without exception. Drilling before receipt of approval is a violation of District Rules and subject to a maximum penalty of \$10,000 per day pursuant to District Rules and the Texas Water Code. I hereby certify that I have read the foregoing statements and that all data therein contained are true and correct to the best of my knowledge and belief. Notice: If 1st Exempt well drilled is dry or does not produce sufficient water, 2nd well permit will be required for the 2nd Well or 3rd etc. along with plugging previous Exempt well holes. *Plugging old well holes will stop the contamination of the Aquifer and eliminate accidents along with meeting State and Federal requirements.*

This Notice given by: (Signature of Owner) or Agent Owner

_____ Title

I, hereby, certify that this application has been verified and is in compliance with the Rules of the District.

_____ Date

District Manager