

There will be a \$200.00 Validation Fee per NonExempt Well Permit up front and non- refundable.

Owner/Operator of the Well must Call and make an appointment, Date and Time to meet in person with the Westexgcd manager to fill out permit and go to location before drilling.

(See Information on Page 3)

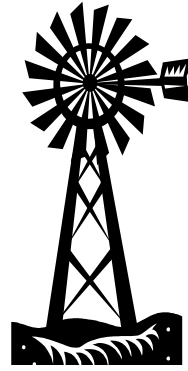

FOR DISTRICT USE ONLY

Well Number _____
Application Date _____
Rec'd By _____
Completion Date _____

Application for ONE *NONEXEMPT* Water Well Registration Permit

1. Well Owner _____

Property Owner & Address, if not well owner _____

Address _____ City _____ State _____ Zip _____

Phone _____ Fax _____

E-Mail _____

911 System address of property of well location _____

2. Well Location _____ County Nolan

NW ¼ NE ¼ SW ¼ SE ¼ Section _____ Block _____ Survey _____

(Circle One that Applies)

_____ miles N or S and _____ miles E or W of the town of _____

(Circle)

(Circle)

_____ measured yards N or S (property) or (section) line and

(Circle all that apply)

_____ measured yards E or W, (property) or (section) line

(Circle all that apply)

_____ measured yards from nearest existing well. Name of nearest well owner, if not applicant _____.

Latitude _____ Longitude _____ (Required for permit)

3. Well Description:

Anticipated Drill Date _____ (If an existing well, then drill date)

Driller _____

Casing Size _____ Pump Size _____ Depth (if known) _____

Estimated or anticipated annual pumpage _____

Estimated or anticipated GPM _____

4. Well Use: Domestic Municipal Industrial Commercial Livestock Irrigation
 (Circle One that Applies)

Other _____ Please Explain Other

Is, or will, water produced from this well be exported beyond the boundaries of Nolan County? _____ If yes, please explain _____

5. Locate well by marking a dot inside a circle (•) **within the grid** to show proposed or existing well locations. The grid represents one section or square mile as described on page 1.

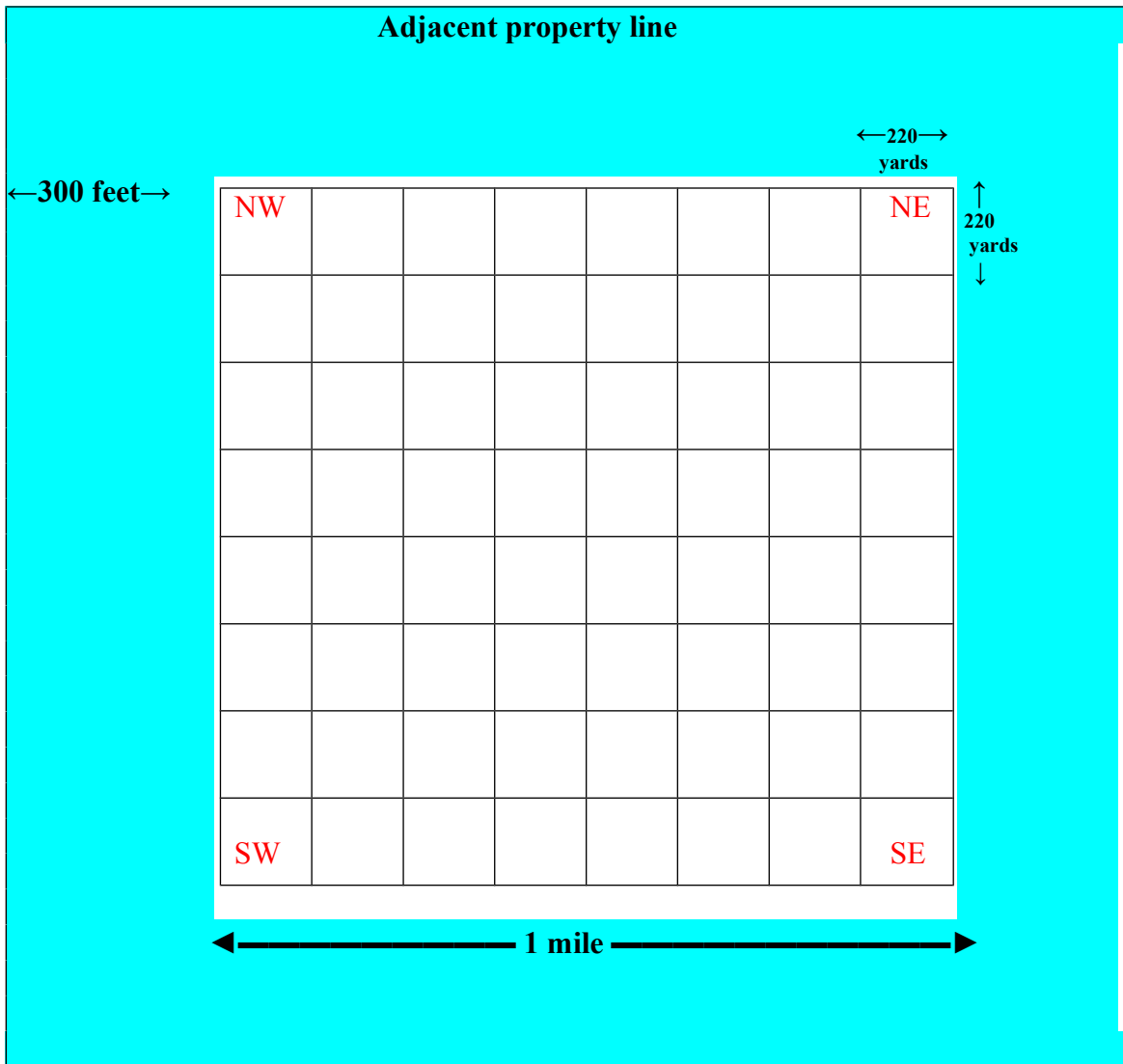

_____ Number of Surveyed Acres in Section Area. (Required)

_____ Number of Wells Currently Existing in Section. (Required)

I agree that this well exists or will be drilled within 3-4 feet of the GPS location specified and not elsewhere, while in accordance to the spacing requirements as set up within the Wes-Tex GCD (Nolan County) Rules and that I will furnish the Board of Directors the completed well log immediately upon completion of this well and prior to the production of water. I agree that the water withdrawn under this application will be put to a beneficial, non wasteful use, and that I will comply with all Wes-Tex GCD District Rules, orders, and permit provisions. I will comply with water well plugging and capping guidelines set forth by the District. I understand that all spacing requirements or production will be subject to inspection by the Water District under Chapter 36.123 to assure compliance.

Notice: All Irrigation or Non-Exempt Wells, regardless of casing diameter must be spaced a minimum of 300 feet from the nearest property line and a minimum of 600 feet from any existing well. All non-exempt well Applications may be subject to approval by the Board of Directors, and no drilling for any such well may commence prior to District approval. All Permit Applications must be approved prior to commencement of drilling without exception. Drilling before receipt of approval is a violation of District Rules and subject to a maximum penalty of \$10,000 per day pursuant to District Rules and the Texas Water Code. Permits will not be taken by email or by anyone other than the owner/operator. (No Agents)

The Westex Groundwater Conservation District personel will Validate the Location of the Well by GPS before the well is drilled and after it is drilled. The well density will also be checked for # of wells, # of acres. If the wells do not meet the requirements or there is any kind of *Questionable Variable*, the permit or permits will not be approved. Then the Permit or Permits will go before the Board of directors at the next meeting.

I hereby certify that I have read the foregoing statements and that all data therein contained is true and correct.

This Notice given by:

(Signature of Owner

Title

I, hereby, certify that this application has been verified and is in compliance with the Rules of the District.

District Manager

Date

Wes-Tex Groundwater Conservation District
100 East Third Street, Suite 305 B
Sweetwater, Texas 79556
325-236-6033
westexgcd.org